

A small-size piezoelectric radio siren is designed to work with the Pandora security systems. All control commands are transmitted from a base unit to the siren via a Bluetooth protocol.

**ATTENTION! The siren can work with the system equipped with:**  
**Bluetooth 4.2 and Firmware v2.18 and higher;**  
**Bluetooth 5.0 and Firmware v3.05 and higher.**

## FEATURES

- Control of Bluetooth connection – the siren monitors the presence of the Bluetooth connection with the base unit when armed. In case of loss of connection, the siren will go into alarm mode for 30 seconds.  
Setting: Inputs and outputs → Mode of Bluetooth siren operation (With/without control of BT-connection).
- External temperature sensor.  
Setting: General settings → Temperature sensors → Select engine/interior/exterior temperature sensor (RHM/PS).
- Input IN RHM/PS with adjustable operation logic.  
Setting: Inputs and outputs → Settings of RHM,PS input → Polarity of IN RHM,PS input; Inputs and outputs → Inputs → IN RHM/PS (NO/NC).
- Output CH BLE PS with adjustable operation logic.  
Setting: Inputs and outputs → Outputs → CH BLE PS. Time channel → Select channel → PS.

## PAIRING WITH A SECURITY SYSTEM

Enter the programming level "Pairing an additional device RHM-03BT or PS-331BT":

- Connect the wires "4 (Green) – PROGRAMMING" and "2 (Black) GROUND(-)". Connect them to the ground (-).
- Connect the wire "1 (Red) – POWER SUPPLY (+12V)" to a constant power supply (+12V).
- The system will confirm pairing with a sound signal from the Siren/Beeper.
- Pairing will be finished automatically or it will be required to press the VALET button to finish. It depends on a system model.
- Exit programming mode;
- Disconnect the wire "4 (Green) – PROGRAMMING" and insulate all unused wires. Connect the power supply wires to the constant power supply circuits of a vehicle.

## SPECIFICATION

Sound Pressure, db:	120
Voltage:	12
Current consumption, mA:	no more than 1
Current consumption in active mode, mA:	300
Data transmission protocol of 2.4GHz:	Bluetooth 4.2 Low Energy
IP code	IP67
Operating temperature, °C:	from -40 to +85
Dimensions, mm:	88x62.2x18.2

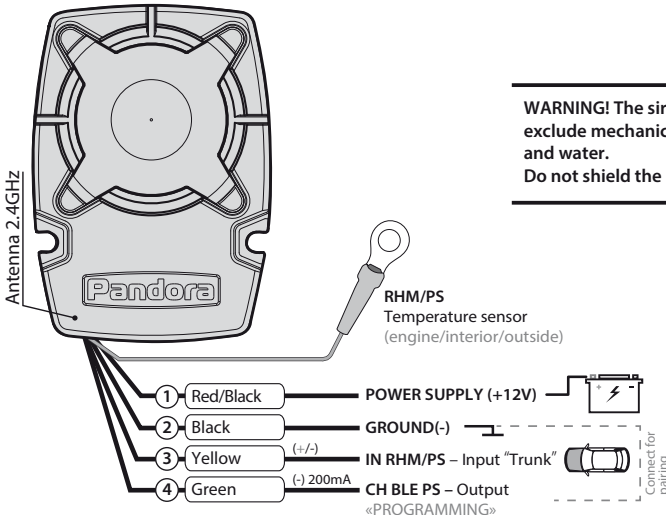

**WARNING! The siren must be installed in the places that exclude mechanical damage and ingress of corrosive liquids and water.**  
**Do not shield the built-in antenna.**

Web-site:  
[pandorainfo.com](http://pandorainfo.com)  
 Customer support:  
[support@pandorainfo.com](mailto:support@pandorainfo.com)

v 1.0