

Pandora

This RF module is designed to control a security system by remote controls at a frequency of 868 MHz

RF Module RFM-470

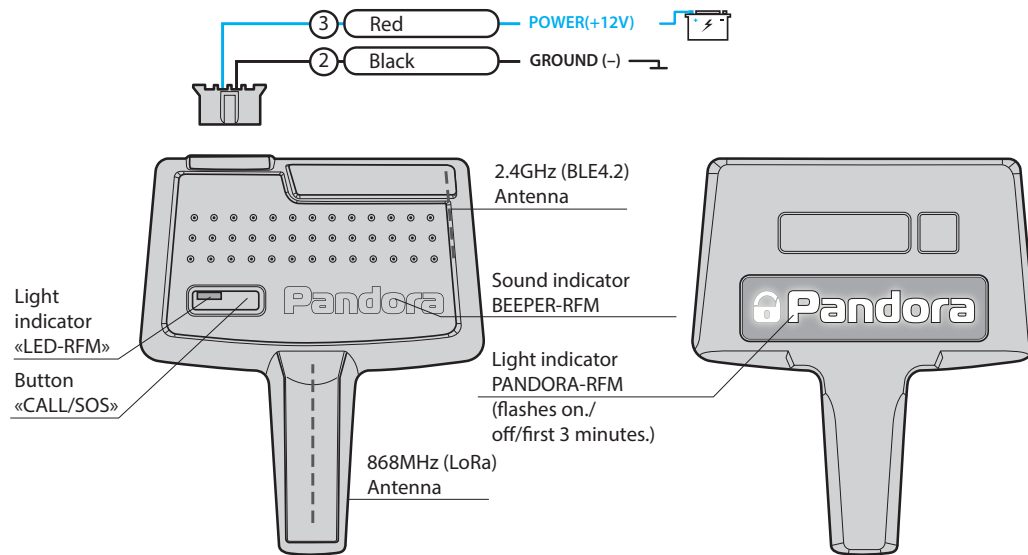

COMPATIBILITY

The module is compatible with the systems that has Bluetooth 5.0 interface and firmware version 4.04 and higher: Pandora Elite v2.

FEATURES

- **868MHz Antenna, LoRa-modulation, dialog encryption (128bit)** – up to 4 remote controls D-043
- **CALL/SOS** – multifunction button
- **LED-RFM** – LED indicator of the CALL/SOS button
- **PANDORA-RFM** – LED indicator of security mode
- **BEEPER-RFM** – sound indicator
- **2.4GHz Antenna, Bluetooth 4.2** – wireless connection with a security system
- **12V Power supply** – own power supply

The module is designed to work at the temperature from -40°C to +85°C, IP40.

FUNCTIONS OF THE CALL/SOS BUTTON

The multifunction CALL/SOS button with the built-in LED-RFM indicator is used to control a security system in case of emergency and notify phone numbers recorded in the system.

Emergency disarming – enter the “Secret PIN-code” that is written on the Owner’s personal card. The system will be disarmed if you enter a correct PIN:

- Press the CALL/SOS button the number of times equal to the first digit.
- Pauses between presses should not exceed 1 second. Pause for more than 1 second confirms the input of the first digit.
- Enter the second, third and fourth digits in the same manner.

Emergency deactivation of the anti-theft functions – turn on ignition and start to enter

the “Secret PIN-code” within 10 seconds. When you enter a correct PIN, the system will deactivate the anti-theft functions until the ignition is turned off:

- Press the CALL/SOS button the number of times equal to the first digit.
- Pauses between presses should not exceed 1 second. Pause for more than 1 second confirms the input of the first digit.
- Enter the second, third and fourth digits in the same manner.

Emergency SOS notification – Owner’s personal safety function. The system will make alternate notification to the programmed phone numbers:

- Press and hold the CALL/SOS button for 3 seconds (until the third sound signal of the BEEPER-RFM)
- ! THIS FUNCTION IS NOT AVAILABLE FOR 10 SECONDS AFTER TURNING ON THE IGNITION (THIS TIME IS RESERVED FOR EMERGENCY DEACTIVATION OF THE ANTI-THEFT FUNCTIONS).



It is required to set-up notifications on the pandora-on.com

Voice and SMS notification settings

- Go the SETTINGS -> NOTIFICATIONS menu
- Add notifications for the “Accident”  type to any programmed phone number:

 SMS notification “SOS + a link to the map with current location”;

 Voice notification: “Owner is in danger”;

 Voice and  SMS notification: “Owner is in danger, current coordinates are sent by SMS” and “SOS + a link to the map with current location”.

PUSH notifications settings

- Go the SETTINGS -> NOTIFICATIONS menu
- Go to the ADMINISTRATIVE SETTINGS -> RULES;

- Select the “CRASH!” type in the Notifications rule  :
PUSH notification Emergency call by a command from remote.

CALL driver function - owner notification function. The system will call the owner’s phone number and play the “Greeting ringtone”. The remote control will indicate “call” 

! THIS FUNCTION IS NOT AVAILABLE WHEN THE SYSTEM IS ARMED AND FOR 10 SECONDS AFTER TURNING ON THE IGNITION (THIS TIME IS RESERVED FOR EMERGENCY DEACTIVATION OF THE ANTI-THEFT FUNCTIONS).

INSTALLATION

STEP 1 – connect power supply of the module:

- Connect the wire 2 (Black) to a grounded spot of a car;
- Connect the wire 3 (Red) to constant +12V

STEP 2 – pair the module with a security system:

- Enter the programming level №10.11;
- If the LED is green, the system is ready for pairing;
- Press and hold the CALL/SOS button on the RF module until the sixth beep of the BEEPER-RFM (sixth flash of the BEEPER-LED)
- If pairing was successful - the BEEPER-RFM of the module and the Siren/Beeper of the system will sound a beep and the LED will light red. The system will enter the programming level №0.

STEP 3 – settings:

- 1.8.3 – Flashes of the Pandora LED when the system is armed (Flashes off / Flashes on / First 3 minutes);
- 1.9 – P factor of RF-module (1-127).

PAIRING REMOTE CONTROLS D-043

Prepare all remote control for pairing. Charge them and turn on in accordance with the manuals. The remote controls are recorded to the memory of the RF-module that was previously paired with a security system. The maximum number of paired remote controls is.

All remote controls that was previously paired will be removed when you pair new ones. Remote controls are paired one by one in any order and without time limit.

The last remote control can be directly paired with the system by Bluetooth. To do this:

- Enable the "BLE-CHANNEL" function in the remote control (SETTINGS -> SETTINGS -> BLE-CHANNEL -> Enable);
- Remove the previously paired device at the level № 1 "Pairing a control device D/030/D043/Watch2" of the system
- Pair remote control(s) with the module in accordance with the manual

Pairing remote controls:

STEP 1 – Enter the programming mode:
Enter the programming mode of the system, level №0

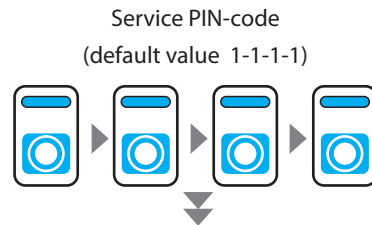

STEP 2 – Enter the pairing mode of the RF-module:

▶▶ Briefly press the CALL/SOS on the RF module

▶ If the LED is green and the Siren/beeper sounded a beep 1x the system is ready for pairing

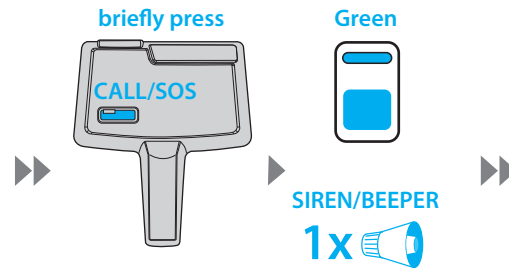

STEP 3 – pair the first remote control:

▶▶ Press and hold 3 buttons of the remote control ①+②+③, release the buttons after the first sound signal 1x of the remote and a red flash of the SEND/ALARM indicator

▶ If pairing was successful, the Siren/beeper - Will sound a beep 1x

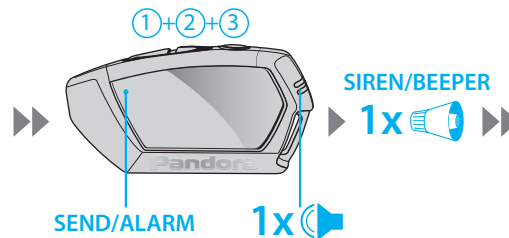

STEP 4 – Pair the remote controls №2, №3, №4:

▶▶ Repeat the STEP 3 for all other remotes

▶ The last remote control can be paired directly with the system by Bluetooth, if a remote control is ready for pairing via Bluetooth, it will indicate «Bluetooth»

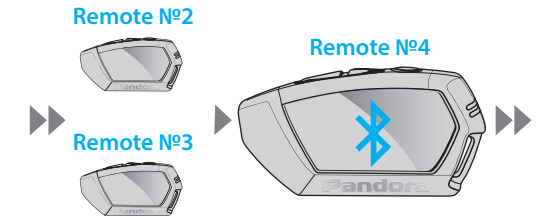

STEP 5 – Finish pairing:

▶▶ Briefly press the CALL/SOS button of the RF-module or the VALET button of the system to finish the pairing process. The system will enter the programming level №1

▶ The system will confirm finishing with a sound signal 1x of the «Siren/beeper» and green light of the LED (red light means that a device was previously paired), the system will enter the programming level 1

When pairing remote controls with the RF-module is completed, the system enter to the level 1 "№1 – Pairing a control device D030/D043/Watch2" within 1 minute to pair the

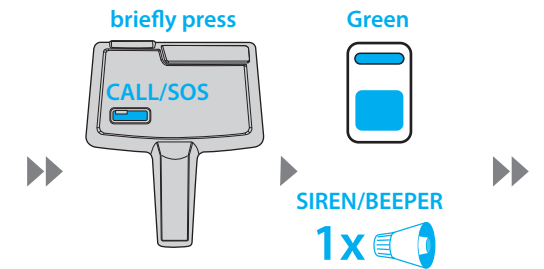

last remote control via Bluetooth interface. If necessary, skip the step by briefly pressing the VALET button.

STEP 6 – Pair the remote control with a system by Bluetooth:

▶▶ The system automatically search and pair the remote control via Bluetooth within 1 minute

▶ Successful pairing will be confirmed with 3x sound signal of the remote control 1x sound signal of the Siren/beeper and red light of the «LED». The system will enter the programming level №0.

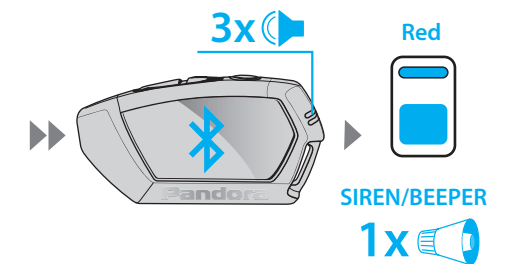

Our web-site: pandorainfo.com
Customer support: support@pandorainfo.com

v 1.0

The quality management system of the manufacturer is certified in accordance with IATF 16949: 2016, ISO 9001:2015



Product is in conformity with Electromagnetic Compatibility Directive EMC 2004/108/EC and R&TTE Directive 1999/5/EC

